

Brownfield Land Register 2025

| | |
|-----------------|---|
| Local authority | Gosport Borough Council |
| URL | http://opendatacommunities.org/id/geography/administration/nmd/E07000088 |

| | | | |
|----------------|--------------------------------------|--------------|------------|
| Site reference | BR14 | | |
| Site name | Priddy's Hard, Heritage Way, Gosport | | |
| Site address | Heritage Way, Gosport, PO12 4GH | | |
| Coordinate ref | ETRS89 | | |
| Geo x | 50.806537 | Geo y | -1.127447 |
| Date added | 15/12/2017 | Date updated | 06/11/2024 |

| | | | |
|-----------------|--|--|--|
| Ownership | Not owned by a public authority | | |
| Policy context | Land is partly within the Priddy's Hard Heritage Area, which is identified for mixed use redevelopment under Policy LP9A. The land also contains the Priddy's Hard Conservation Area, which includes a number of listed buildings and a Scheduled Ancient Monument. The site is potentially contaminated while parts fall within Flood Zone 2 and 3. | | |
| Planning status | 17/00599/FULL – hybrid application for 30 dwellings, as well as holiday lets, a distillery and associated staff offices, volunteer accommodation, a new museum, and a storehouse Granted permission 27 th September 2019. Complete. | | |
| Deliverable | Yes – development is expected within five years. | | |
| Site size | 9.86 ha | | |
| Housing range | Up to 120 | | |
| Non-residential | Policy LP9A includes commercial, community and leisure uses (approx. 1,400 sqm) and a new park at the Ramparts. | | |
| Comments | The 30 dwellings in application 17/00599/OUT are in addition to the 100 allocated in Policy LP9A (this 100 dwellings was reassessed with a capacity of 120 dwellings in the draft Regulation 18 Policy in the Gosport Borough Local Plan 2038). | | |

Site plan

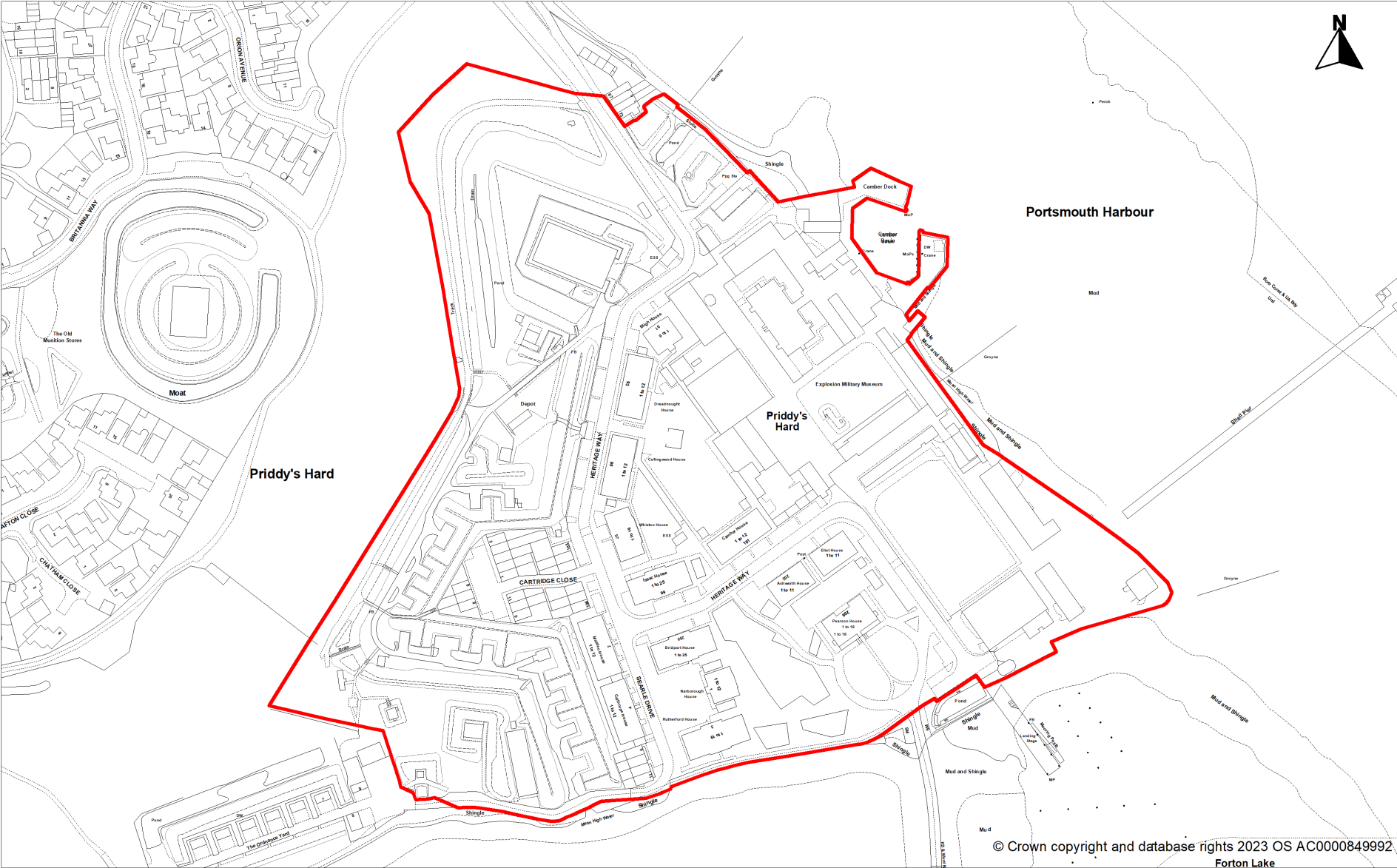

1:2500



DATE : 12/12/2023

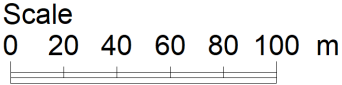

If this map has been transmitted electronically, use the scale bar in preference to the written scale

You are permitted to use this data solely to enable you to respond to, or interact with, the organisation that provided you with the data. You are not permitted to copy, sub-license, distribute, or sell any of this data to third parties in any form.